

# NOVOTEL

Novotel Ambassador Seoul Gangnam

01.

# Hotel **INTRODUCTION**

# NOVOTEL

AMBASSADOR SEOUL GANGNAM



Located in the heart of Gangnam's vibrant shopping and dining district, Novotel Ambassador Seoul Gangnam offers convenient access to major public transportation hubs, making it an ideal choice for both business and leisure travelers.

The hotel features 332 rooms, including suites and Premier Executive floors, providing comfort and sophistication for every guest.

With a range of versatile venues, the property is perfectly equipped to host meetings, conferences, and wedding events. Guests can indulge in a variety of contemporary and classic dining experiences and unwind at the state-of-the-art 'Inbalance' fitness center, which includes a heated indoor swimming pool, sauna, and both indoor and outdoor golf ranges.

02.

# Hotel **Room**

# Superior Room

(Double bed/Twin bed) 26~28m<sup>2</sup>



## (A) INTRODUCTION

The Superior rooms are appropriately designed for tourists and business travelers to Seoul. Each room is tastefully designed, boasting a clean atmosphere.

## (B) SERVICE & AMENITIES

- Bedroom
- Bathroom
- Mini bar
- WiFi Internet connectivity
- Free access to the health club and swimming pool
- Personal safe
- Multi-adaptor
- 2 bottles of mineral water
- Coffee and tea
- Bidet

# Deluxe Room

(Double bed/Twin bed/Ondol) 26~28m<sup>2</sup>



## (A) INTRODUCTION

The Deluxe Room designed for business travelers provides more benefits and higher quality of service.

## (B) SERVICE & AMENITIES

- Bedroom
- Bathroom
- Mini bar
- WiFi Internet connectivity
- Free access to the health club and swimming pool, Sauna
- Personal safe
- Multi-adaptor
- 2 bottles of mineral water
- Coffee and tea
- Bidet

# Executive Room

(Double bed/Twin bed) 26~28m<sup>2</sup>



## (A) INTRODUCTION

The Executive Room guarantees the privacy of its guests and comes with unmatched superior service to ensure a luxurious experience. The various special services provided at the Premier Executive Lounge located on the 16th floor guarantee the comfort and convenience of its guests.

## (B) SERVICE & AMENITIES

- Bedroom
- Bathroom
- Mini bar
- WiFi Internet connectivity
- Free access to the health club and swimming pool, Sauna
- Free Lounge access (Happy hour)
- Personal safe
- Multi-adaptor
- 2 bottles of mineral water
- Complimentary coffee with Nespresso coffee maker
- Bidet

# Premier Suite Room

Premier Suite Size: 54.5m<sup>2</sup>

Novotel Suite Size: 82.4m<sup>2</sup>



## (A) INTRODUCTION

The Premier Suite and Novotel Suite, where the bedroom is separated from the living room, provides space for work and relaxation all at once.

In particular, the Novotel Suite has a bathroom that can be accessed from the comfortably furnished bedroom and is equipped with a Jacuzzi to provide added relaxation for the guests.

## (B) SERVICE & AMENITIES

- Bedroom
- Bathroom
- Mini bar
- WiFi Internet connectivity
- Free access to the health club and swimming pool, Sauna
- Free Lounge access (Happy hour)
- Personal safe
- Multi-adaptor
- 2 bottles of mineral water
- Complimentary coffee with Nespresso coffee maker
- Bidet



03.

# Hotel **Meeting Rooms**

## 2F | MEETINGS & EVENTS

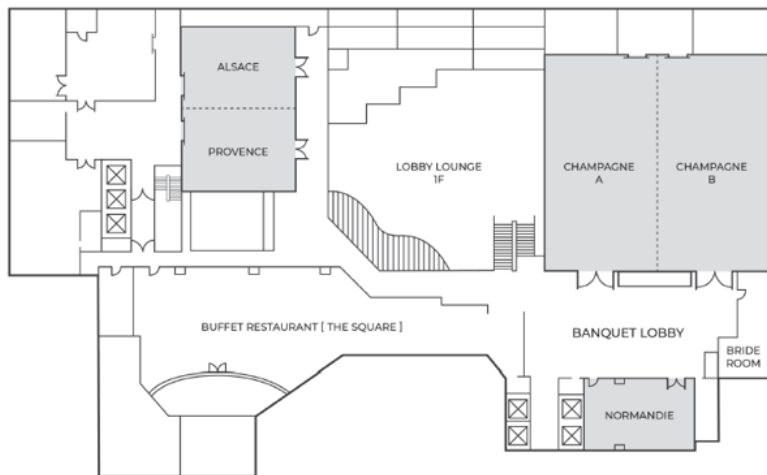

MEETING ROOM	SIZE				CAPACITY				
	Dimension (m <sup>2</sup> )	Width (m)	Length (m)	Height (m)	Banquet	Theatre Style	Classroom Style	U-Shaped Room	Standing Cocktail
CHAMPAGNE A B	495	20	22	4.3	240	400	240	51	360
ALSACE & PROVENCE	185	11	17	3.5	90	98	72	39	90
NORMANDIE	76	6	10	3.5	40	40	24	21	40

## LOWER LOBBY | MEETINGS & EVENTS

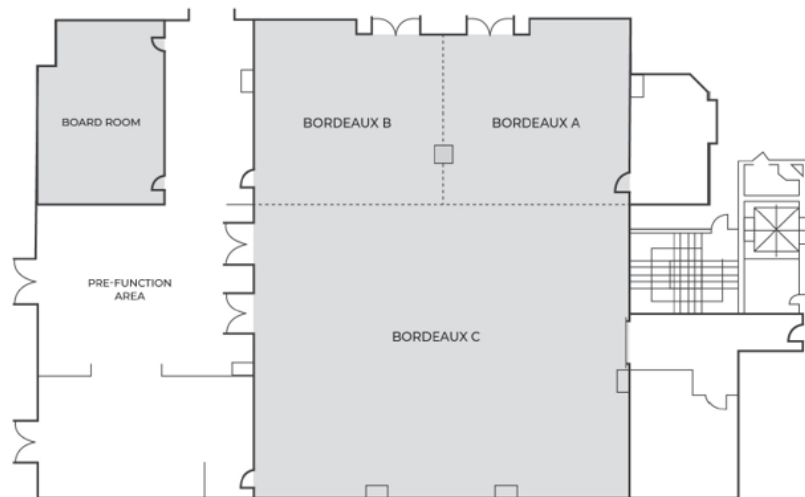

MEETING ROOM	SIZE				CAPACITY				
	Dimension (m <sup>2</sup> )	Width (m)	Length (m)	Height (m)	Banquet	Theatre Style	Classroom Style	U-Shaped Room	Standing Cocktail
BORDEAUX A B C	314	14	20	2.7	140	160	105	42	200
BOARD ROOM	32	4	8	2.7	Only - I shape for 16 Seats				

# Champagne Hall

495 m<sup>2</sup> / 2F

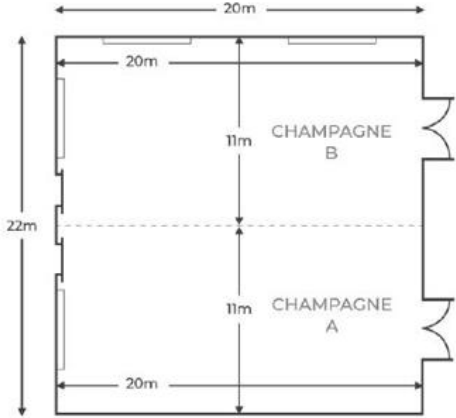

Height : 4.3m

## CAPACITY | PERSONS

BANQUET 240

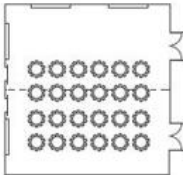

CLASSROOM 240

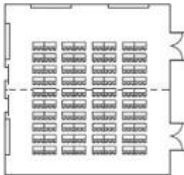

U-SHAPE 51

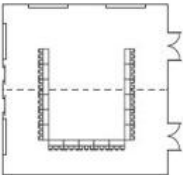

# Alsace & Provence Hall

185 m<sup>2</sup> / 2F

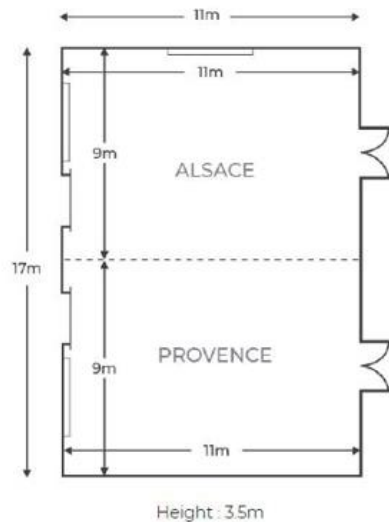

## CAPACITY | PERSONS

BANQUET 90

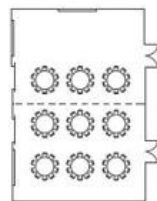

CLASSROOM 72



U-SHAPE 39

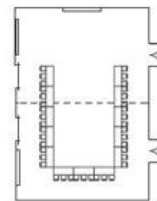

# Normandie Hall

76 m<sup>2</sup> / 2F

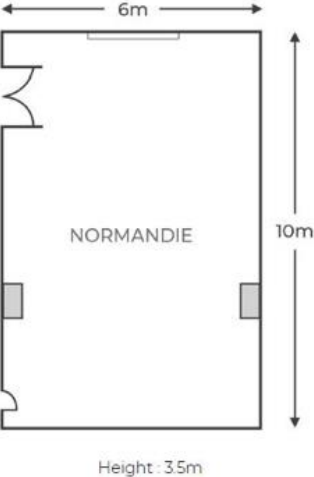

### CAPACITY | PERSONS

BANQUET 40

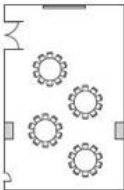

CLASSROOM 24

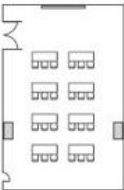

U-SHAPE 21

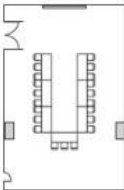



# Bordeaux Hall

314 m<sup>2</sup> / LLF

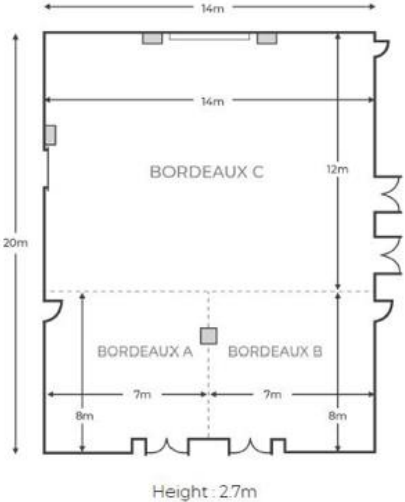
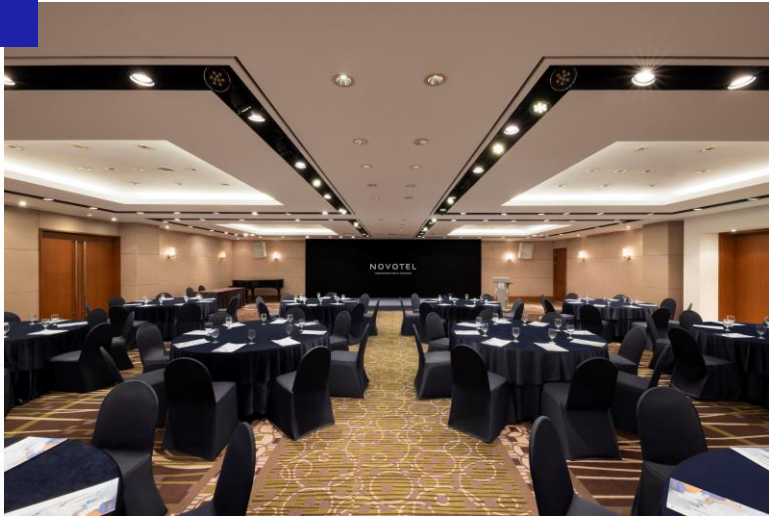

## CAPACITY | PERSONS

BANQUET 140

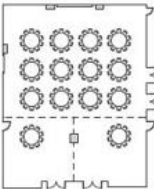

CLASSROOM 105

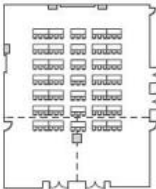

U-SHAPE 42

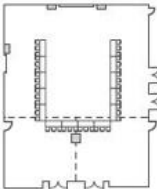

04.

# Hotel **Restaurants**

# The Square

Buffet restaurant 'The Square'  
Seats : 198 | 2F



Gourmet hotel buffet, The Square, features diverse Korean, Japanese, Chinese, Western, and American favorites. With a comfortable atmosphere and modern interior, The Square, is an ideal venue for business and family gatherings.

# Entrée

Contemporary Dining 'Entrée'  
Seats : 76 | Lobby



Entrée is a contemporary dining restaurant featuring Western and Korean cuisines, prepared with quality ingredients in a modern style.



# Woobriand

Korean BBQ Dining 'Woobriand'  
Seats : 34 | Lower Lobby



The True Definition of Gourmet in Gangnam.

Invite you to a premium selection of Korean beef at Woobriand.

Now, the new standard of Korean Omakase is born with the finest aged Han-woo BMS No.9 grade and premium wine selection.

# HongBoGak

Chinese Fine Dining 'HongBoGak'  
Seats : 98 | Lower Lobby



"Hongbogak", a Chinese fine dining restaurant owned by renowned Chinese cuisine expert Chef Ye Kyong-rae, showcases an authentic selection of Chinese dishes inspired by various regional styles—including Beijing, Cantonese, and Sichuan—offering a rich and diverse culinary experience beyond any single tradition.

## Lobby Lounge

Café and Meeting place 'Lobby Lounge'  
Seats : 70 | Lobby



Lobby Lounge features a variety of coffee options, cocktails, teas, and other beverages, along with various desserts and simple meal options as well as a quiet atmosphere for daytime business meetings.

## Gran A II

Lounge Bar 'Gran A II'  
Seats : 180 | Lobby



Perfect for social events and business gatherings in Gangnam, Gran A II's menu features a wide array of whiskey, cocktails, beer, and other beverages.

05.

# Hotel **Facilities**

## Premier Lounge

Floor: 16F

Operation Time:06:00~22:00



- Operation: 06:00~22:00
- Private check in & out service
- Offering breakfast and happy hour
- Complimentary using meeting room (2 hours)

## Fitness Club

Floor: 3F

Operation Time:06:00~22:00



- Fully equipped swimming pool
- Sauna
- Outside Jacuzzi
- Gym
- Indoor / outdoor golf range

06.

# Hotel **Location**



## NOVOTEL AMBASSADOR SEOUL GANGNAM

130 Bongeunsa-ro, Gangnam-Gu, Seoul, 06124, Korea

T. +82(0)2 567-1101

### Bus

KAL-limousine #6703 (T1: 4A, 3B / T2: 19)

stop at hotel front door/ takes 1h 30min.

Adult: 18,000KRW Children (6~12): 12,000KRW

### Subway

Take AREX. Transfer at Gimpo Intl' Airport Stn. to Line #9 to Shinnonhyun Stn.

Come out of exit 4 and keep on following the road / takes 1h 30min.

Appx. Fare: 6,000 KRW

### Taxi

The fastest way/ takes 1h 10min

Appx. Fare: 80,000~100,000KRW

